



# BUILDING & SAFETY DIVISION

# STANDARD CMU WALL DETAIL FOR STREET FACING WALLS

**Applicability:** This standard detail can be used for the construction of street-facing-walls only.

**Process:** Inquire with the Planning Division if a Minor or Major Site Plan Review application is required depending on the cubic yard of soil affected. Planning Division contact information: [Planning@rpvca.gov](mailto:Planning@rpvca.gov) / 310-544-5287

**Permitting:** Once you obtain your Planning Clearance, submit your site plan and application to the Building and Safety Division. You can do so in person or through [BuildingSafety@rpvca.gov](mailto:BuildingSafety@rpvca.gov)

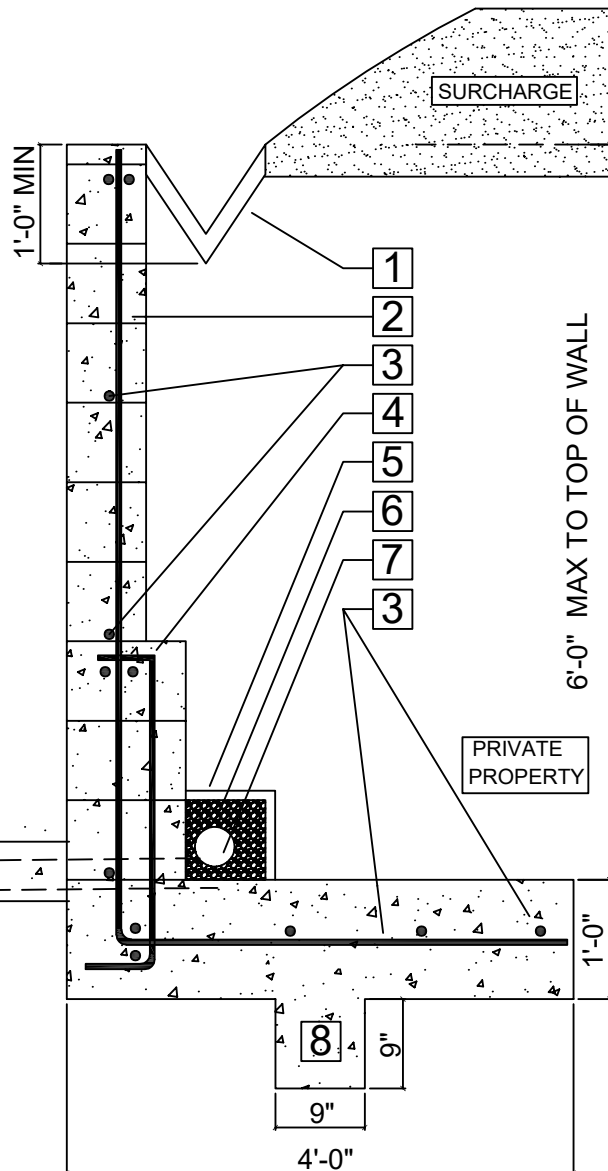

KEY NOTES	
1	12" WIDE SWALE (AS NEEDED)
2	#4 REBAR @ 16" O.C. VERTICAL
3	#4 REBAR @ 16" O.C. HORIZONTAL
4	CROSSED LOOP TIES #4 REBAR @ 16" O.C.
5	FILTER FABRIC
6	3/4" GRAVEL- 12" DIAMETER AREA
7	4" DIAMETER PERFORATED DRAIN PIPE-2% SLOPE TO END OF WALL
8	9"x9" KEY
9	3" DRAIN PIPE THROUGH SIDEWALK/CURB INSTALLED AT DOWNHILL END OF WALL
10	6" THICK MINIMUM CURB FACE

**Disclaimer:** This is a standard detail to facilitate the process of obtaining the permit for and constructing a street-facing retaining wall. This standard detail does not take into account the specific geological conditions pertaining to your specific property as is required in the general Retaining Wall Procedure. Therefore by choosing to use this detail in lieu of the general procedure, the city will pertain no liability in the longevity or future of the wall.

### STRUCTURAL NOTES:

- FOOTINGS/ FOUNDATION TO BE MINIMUM 3000 PSI CONCRETE
- EVERY OTHER CMU CELL TO BE FILLED WITH MINIMUM 2500 PSI CONCRETE
- RETAINING WALL DAMP-PROOFING TO BE INSPECTED PRIOR TO BACKFILL
- ALL REINFORCING STEEL TO BE MINIMUM #4 (1/2" DIA.) REBAR SHALL MEET THE FOLLOWING CLEARANCES: 3" FROM BOTTOM OF FOOTING... 2" FROM TOP OF FOOTING... 2 1/2" FROM EXTERIOR SIDES OF CMU
- 3 BASE LAYERS OF 8"x12"x16" CMU... ADDITIONAL LAYERS OF WALL CAN BE 8"x8"x16"
- REINFORCING STEEL SHALL OVERLAP A MINIMUM OF 12"



## STANDARD CMU WALL DETAIL FOR STREET-FACING WALLS

RANCHO PALOS VERDES - BUILDING & SAFETY DIVISION

30940 Hawthorne Boulevard  
Rancho Palos Verdes, CA 90275  
310-544-5280 - [Buildingsafety@rpvca.gov](mailto:Buildingsafety@rpvca.gov)

REV 1/1/2023

Page 1 of 1

Drawn by: Brandon Delgado