

SCALE
 HORIZ: 1"=20'
 VERT: 1"=10'

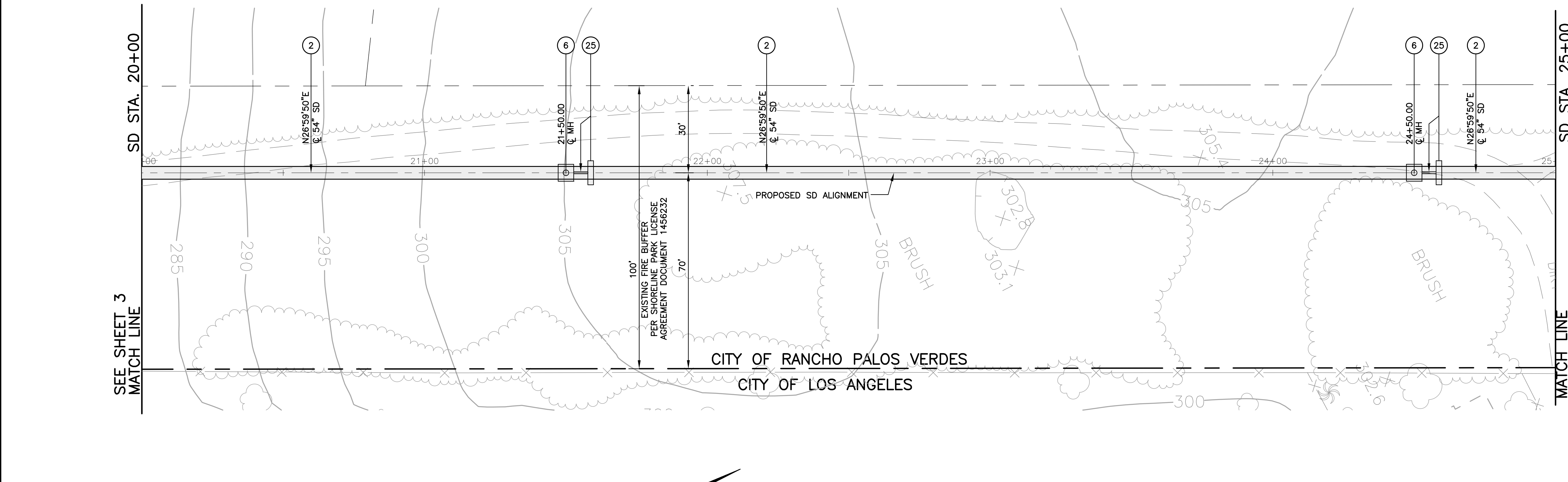

- CONSTRUCTION NOTES**
- (2) CONSTRUCT 54" I.D. CCFRPM PIPE ("HOBAS" PIPE OR APPROVED EQUAL), 1.05-INCH THICK WALL, WITH FWC COUPLING PER OPEN TRENCH SECTION ON SHEET 20.
 - (6) CONSTRUCT MANHOLE STRUCTURE PER MODIFIED STD PLAN NO. 320-1, L=5.5', D1=D2=54", MODIFICATION: CONSTRUCT CCFRPM PIPE CONTINUOUS THROUGH MANHOLE STRUCTURE FROM INVERT TO SPRING LINE. CUT MINIMUM SIZE "HATCH" FROM TOP HALF OF PIPE TO ALLOW MANHOLE ACCESS. CONSTRUCT PRESSURE MANHOLE FRAME AND COVER PER SPPWC STD PLAN NO. 329-1.
 - (8) CONSTRUCT VELOCITY REDUCER CONTROL RING WITH SHOP INSTALLED 6-INCH THICK REINFORCED FIBERGLASS INSIDE 54" I.D. CCFRPM PIPE PER DETAIL 8 ON SHEET 19. PLACE RING MID-WAY IN 20-FOOT LONG PIPE LENGTHS. STATION LOCATION CALL-OUTS ON PROFILE ARE APPROXIMATE AND CAN SHIFT AS LONG AS NUMBER OF RINGS AND SPACING IS MAINTAINED.
 - (8A) CONSTRUCT CONCRETE TRENCH SUPPORT BACKFILL PER DETAIL 8A ON SHEET 19. APPLIES TO VELOCITY REDUCER RINGS IN OPEN TRENCH REACH.
 - (26) CONSTRUCT LEAN PCC SEEPAGE DAM IN MAIN LINE STORM DRAIN TRENCH PER DETAIL 26 ON SHEET 20, COMPLETE WITH 8" PVC (SCH 40) RELIEF SYSTEM TO ADJACENT DOWNSTREAM MANHOLE.

60% DESIGN PLANS
 NOT FOR CONSTRUCTION
 NOVEMBER 1, 2011

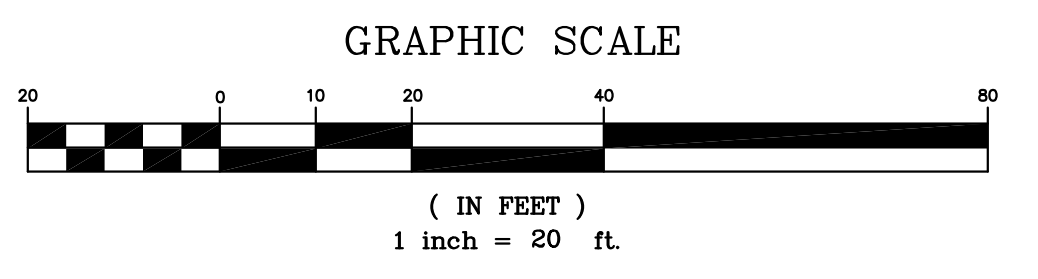
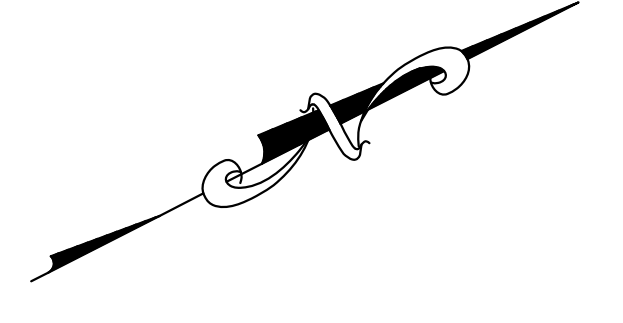

PLAN PREPARED BY:
Harris & Associates
 34 Executive Park, Suite 150
 Irvine, CA 92614 (949) 655-3900
 RANDALL G. BERRY RCE #44642 DATE

CITY OF RANCHO PALOS VERDES
 RON DRAGOO SENIOR ENGINEER DATE
 RCE: 54924

NO.	DATE	DESCRIPTION	APPROVED
REVISIONS			

DESIGNED: RGB/EGR/PL
 DRAWN: EGR/BL
 CHECKED: RGB
 DATE: OCT 11

CITY OF RANCHO PALOS VERDES



SAN RAMON STORM DRAIN
 PLAN AND PROFILE
 STA 20+00 TO STA 25+00

SHEET 4 OF 31
 SHT. 4
 PRJ NO. XXXXX