

ELECTRICAL SYMBOLS

- #— CONDUIT CONCEALED IN WALLS OR CEILING, MINIMUM SIZE CONDUIT 1/2 INCH.
- T.C.O.— CONDUIT CONCEALED IN FLOOR OR UNDERGROUND, MIN. SIZE CONDUIT 3/4 INCH.
- 1/2" 4#4— WHERE OTHER SIZES OF CONDUIT AND/OR CONDUCTORS ARE USED OTHER THAN DENOTED BY HASH MARKS, NOTE SHOWN INDICATES 1/2" CONDUIT WITH 4#4 WIRES.
- A1, B1, C1, D1, E1, F1, G1, H1, I1, J1, K1, L1, M1, N1, O1, P1, Q1, R1, S1, T1, U1, V1, W1, X1, Y1, Z1— CONDUIT RUN TO PANEL (A DENOTES PANEL, 135 DENOTES CIRCUIT NO.)
- NOTE: HASH MARKS ON CONDUIT SYMBOL INDICATES QUANTITY OF #12 WIRES, MAXIMUM OF 3#12 IN 1/2", 5#12 IN 3/4". C.C. DENOTES CONDUIT ONLY USE OF THESE SYMBOLS APPLIES TO ALL CONDUIT UNLESS OTHERWISE NOTED ON PLANS.
- LIGHTING OUTLET FOR FLOORESCENT FIXTURE.
- LIGHTING OUTLET FOR CEILING MOUNTED INCANDESCENT FIXTURE (IDENTIFICATION TYPICAL FOR ALLOUTLETS, "3" DENOTES CIRCUIT NO., "A" DENOTES CONTROLLING SWITCH, "N" DENOTES NIGHT CIRCUIT.)
- LIGHTING OUTLET FOR WALL MOUNTED INCANDESCENT FIXTURE, BRACKET OR RECESSED.
- LIGHTING OUTLET FOR RECESSED INCANDESCENT FIXTURE.
- LIGHTING OUTLET FOR EXTERIOR FLOORLIGHT, TYPE AND NUMBER OF ADAPTERS AS PER FIXTURE SCHEDULE AND NOTES.
- LIGHTING OUTLET FOR BRACKET OR CEILING MOUNTED EXIT LIGHT, PROVIDE DIRECTIONAL ARROWS WHERE INDICATED ON PLANS.
- LIGHTING FIXTURE IDENTIFICATION, FIRST NO. DENOTES QUANTITY OF FIXTURES, 2ND NUMBER "2100" DENOTES 2100 WATT LAMP PER FIXTURE, "A" DENOTES TYPE OF FIXTURE PER FIXTURE SCHEDULE, "10'-0" DENOTES MOUNTING HEIGHT.
- SINGLE POLE WALL SWITCH, "2" DENOTES OUTLET CONTROLLER.
- THREE WAY WALL SWITCH.
- SINGLE POLE KEY SWITCH.
- MOTOR DISCONNECT SNAP SWITCH.
- SWITCH WITH NEON TYPE PILOT LIGHT.
- NOTE: ALL SWITCHES SHALL BE 48" ABOVE FLOOR UNLESS OTHERWISE NOTED.
- NON-FUSED DISCONNECT SWITCH, 30A-2P OR 3P AS REQUIRED IN NEMA 1 ENCLOSURE.
- MAGNETIC MOTOR STARTER, SIZE 1, 2P OR 3P AS REQUIRED IN NEMA 1 ENCLOSURE.
- DUPLEX CONVENIENCE OUTLET, 16" ABOVE FLOOR UNLESS OTHERWISE NOTED.
- POWER OUTLET, 220V 1ϕ, TYPE AS REQUIRED.
- JUNCTION BOX WITH COVER OR ADAPTER AS REQUIRED.
- WATERPROOF FLOOR BOX, RUBBER AND STUCCO 2503 WITH RECEPTACLE.
- MOTOR OUTLET, TYPE AS NOTED ON PLANS.
- FRACTIONAL HP EXHAUST FAN CONTROLLED BY LIGHT SWITCH.
- THE FAN MUST BE FURNISHED AND INSTALLED BY MECHANICAL, OUTLET AND CONDUIT BY ELECTRICAL.
- FLUSH CLOCK OUTLET WITH CLOCK.
- WEATHERPROOF.
- LIGHTING BRANCH CIRCUIT PANEL.
- WALL MOUNTED TELEPHONE OUTLET, 42" ABOVE FLOOR UNLESS OTHERWISE NOTED.
- WATERTIGHT FLOOR BOX FOR TELEPHONE.
- CONDUIT TO TELEPHONE TERMINAL BACK BOARD, "P" DENOTES 3/4" CONDUIT, "P1" DENOTES 1" CONDUIT.

GENERAL NOTES

1. THE ELECTRICAL CONTRACTOR SHALL CHECK WITH OTHER TRADES AND WITH ARCHITECT FOR LOCATIONS OF ELECTRICAL EQUIPMENT BY OTHERS AND FOR LOCATIONS OF CABINETS, MIRRORS, SINKS, ETC., AND CO-ORDINATE INSTALLATION OF ELECTRICAL EQUIPMENT WITH OTHER TRADES.
2. IN EVENT OF A CONFLICT OR INCONSISTENCY BETWEEN ITEMS CALLED-OUT ON PLANS OR IN SPECIFICATIONS OR CONFLICTS WITH CODE REQUIREMENTS APPLYING TO THE SAME MATTER, THAT CALL-OUT SPECIFICATION OR CODE WHICH PRESCRIBES AND ESTABLISHES THE HIGHER STANDARD SHALL TAKE PRECEDENCE AND SHALL BE COMPLIED WITH.
3. SEE MECHANICAL DRAWINGS FOR HEATING, VENTILATING, PLUMBING AND CONTROL WIRING DIAGRAMS, ALSO SEE HEATING, VENTILATING AND PLUMBING SPECIFICATIONS FOR FURTHER CLARIFICATION.
4. ALL CONDUIT STUBS SHALL BE CAPPED WITH MALLEABLE IRON PIPE CAPS AND ALL "CO" SHALL BE PROVIDED WITH #12 GALVANIZED PULL WIRE.
5. ALL CONDUIT NOT OTHERWISE MARKED FOR SIZE AND NUMBER OF CONDUCTORS SHALL BE MINIMUM OF 1/2" WITH 2#12 WIRES.
6. ENGRAVE ALL DEVICE PLATES WHERE DESIGNATIONS ARE SHOWN IN QUOTATION MARKS.
7. PROVIDE ALL FIXTURES OF RATINGS INDICATED IN SCHEDULE, EVEN THROUGH LAMP SIZE IS INDICATED TO BE SMALLER ON PLANS.
8. ELECTRICAL CONTRACTOR SHALL INCLUDE IN HIS BID ALL COST NECESSARY TO FURNISH FIXTURES WITH SPECIAL COLORS WHERE INDICATED, THAT IS, COLORS TO BE SELECTED BY ARCHITECT.
9. ELECTRICAL CONTRACTOR SHALL PROVIDE FIXTURE WITH ALL ACCESSORIES REQUIRED FOR A COMPLETE INSTALLATION AND SHALL PROVIDE THE FIXTURE WITH ANY VARIATIONS FROM STANDARD AS INDICATED BY THE DESCRIPTION, SPECIFICATION OR LOCAL CODE, REGARDLESS OF WHETHER SUCH VARIATIONS ARE INDICATED BY THE CATALOG NUMBER OR NOT.
10. ALL PENDENT MOUNTED FIXTURES SHALL BE PROVIDED WITH 45" BALL ALIGNERS TO PERMIT THE FIXTURES TO HANG STRAIGHT AND PLUMB.

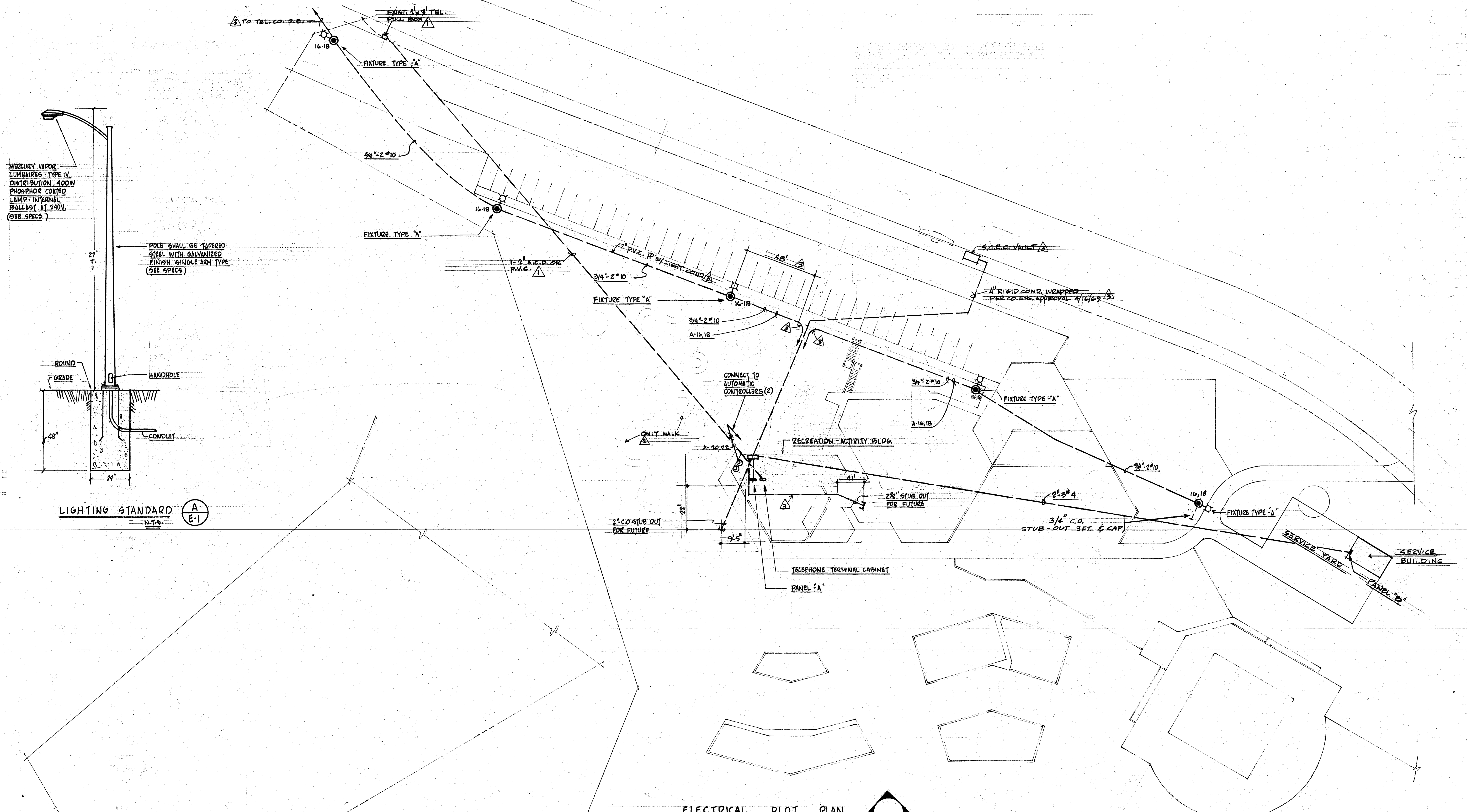

ELECTRICAL PLOT PLAN
SCALE: 1/4" = 30'-0"

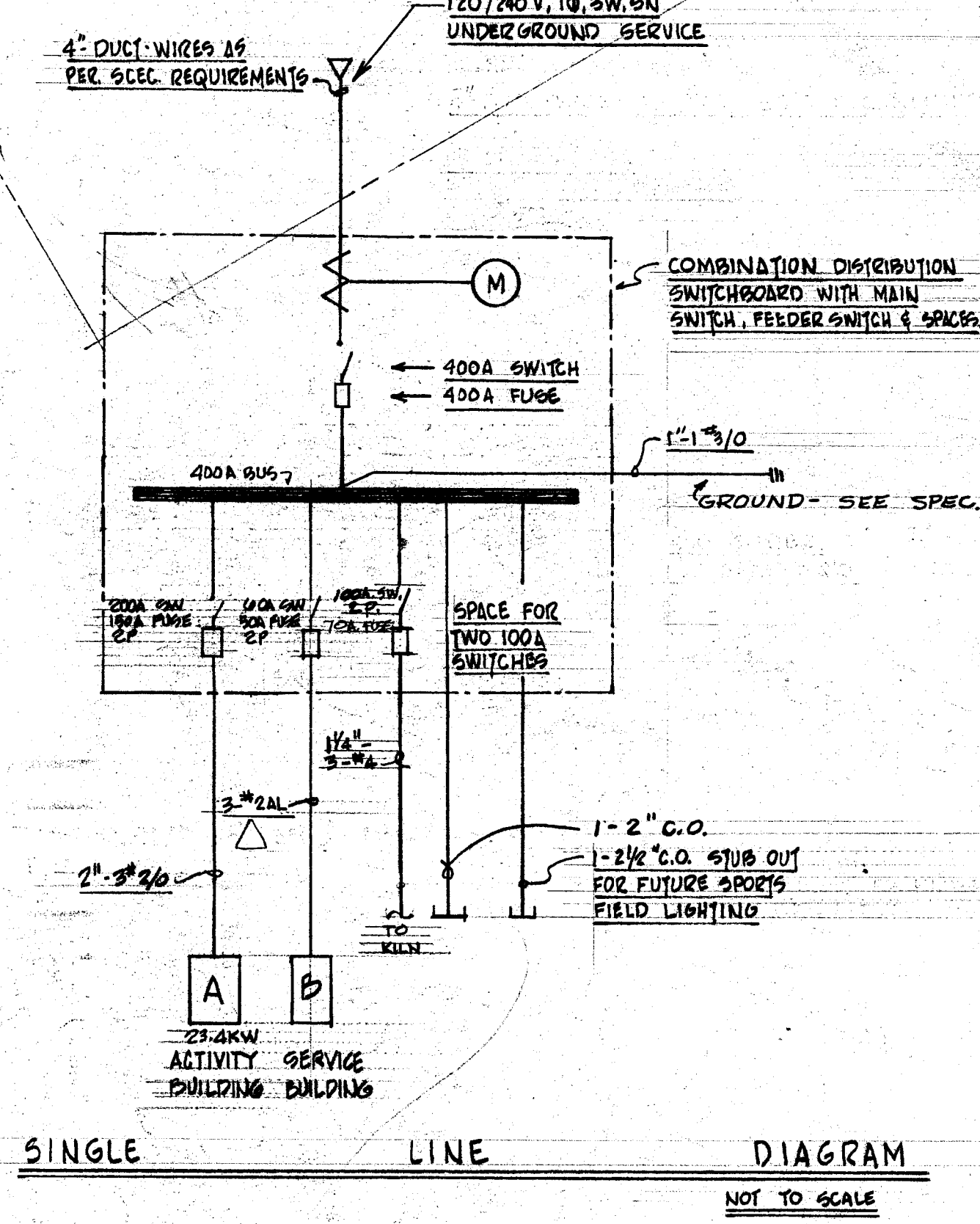

SINGLE LINE DIAGRAM
NOT TO SCALE

EAST FILE CORP., IRVINE, CA
 120
 Electrical plot plan sheet #1 of 2