

TEMPORARY NETTING FENCE FOR EVENTS. NETTING TO BE 20' HIGH WITH TELESCOPING POLES AT 30' O.C.

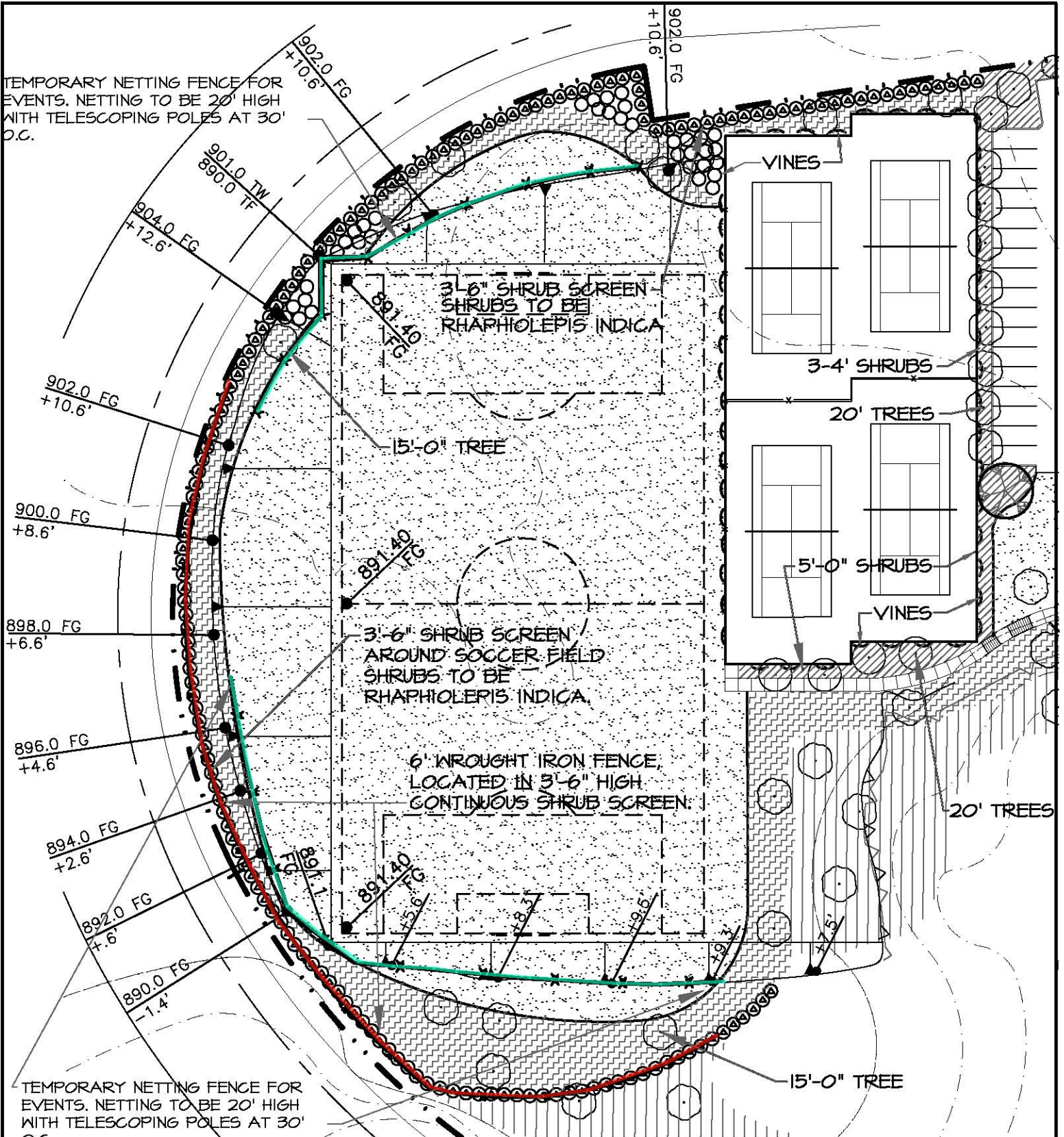

TEMPORARY NETTING FENCE FOR EVENTS. NETTING TO BE 20' HIGH WITH TELESCOPING POLES AT 30' O.C.

PARTIAL SITE PLAN
SCALE: 1" = 60'-0"



NOTE: THE PLAYING SURFACE OF THE SOCCER FIELD IS DEPRESSED (2:1 SLOPE BANK) WITH A CONTINUOUS LANDSCAPE SCREEN AROUND THE FIELD OF APPROXIMATELY 3'-6" FEET TALL, A 6' BLACK IRON FENCE WILL BE EMBEDDED IN THE HEDGE SCREEN, AS SHOWN.

EXHIBIT A SPORTS FIELD/TENNIS COURT PLANTING
30800 PALOS VERDES DRIVE EAST
MARYMOUNT COLLEGE

RASMUSSEN & ASSOCIATES
DECEMBER 1, 2008

Architecture
Planning
Interiors

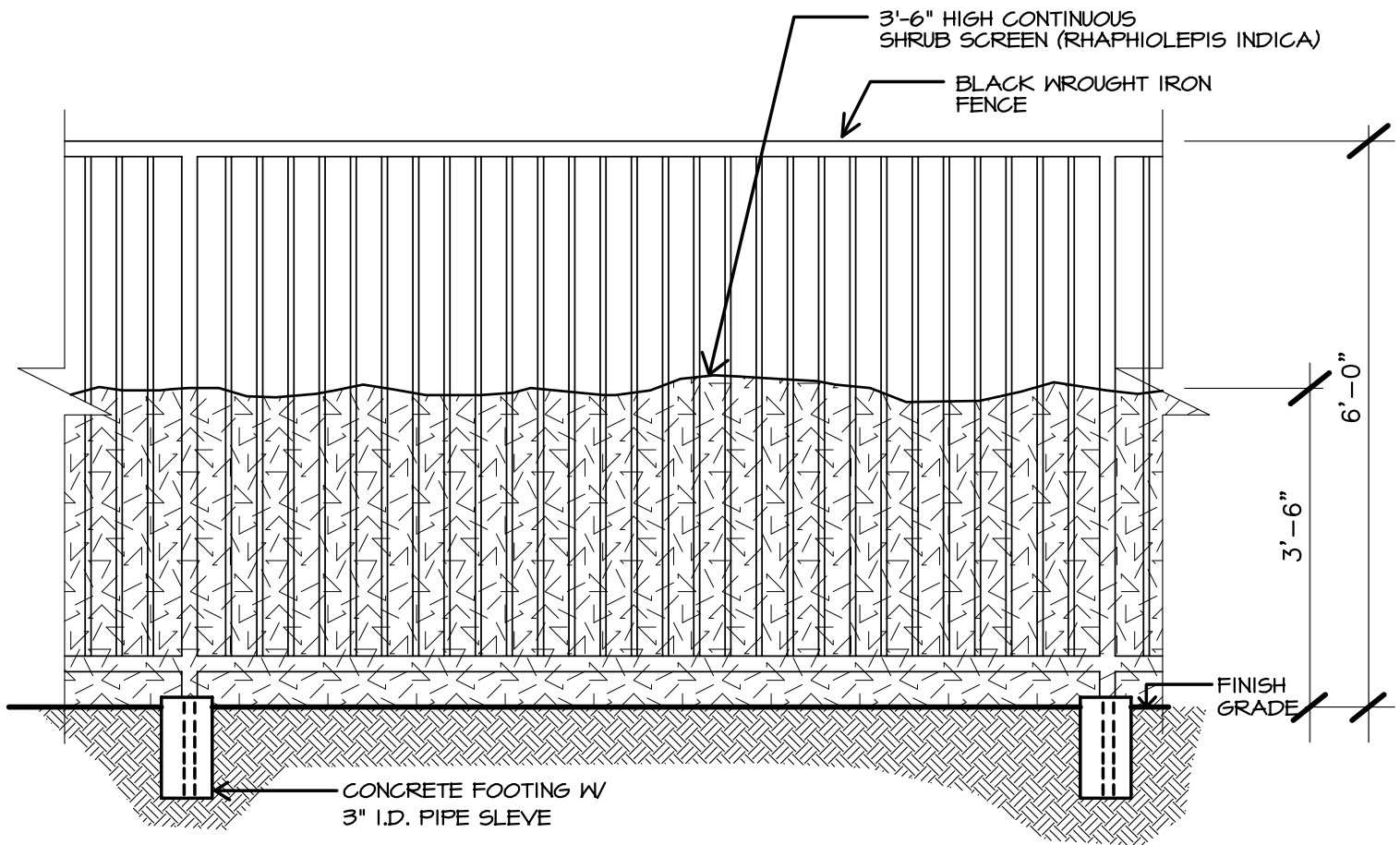

PARTIONAL FENCE ELEVATION
 SCALE: NOT TO SCALE

EXHIBIT C SPORTS FIELD WROUGHT IRON FENCE
 30800 PALOS VERDES DRIVE EAST
 MARYMOUNT COLLEGE

RASMUSSEN & ASSOCIATES
 DECEMBER 15, 2008
 Architecture
 Planning
 Interiors

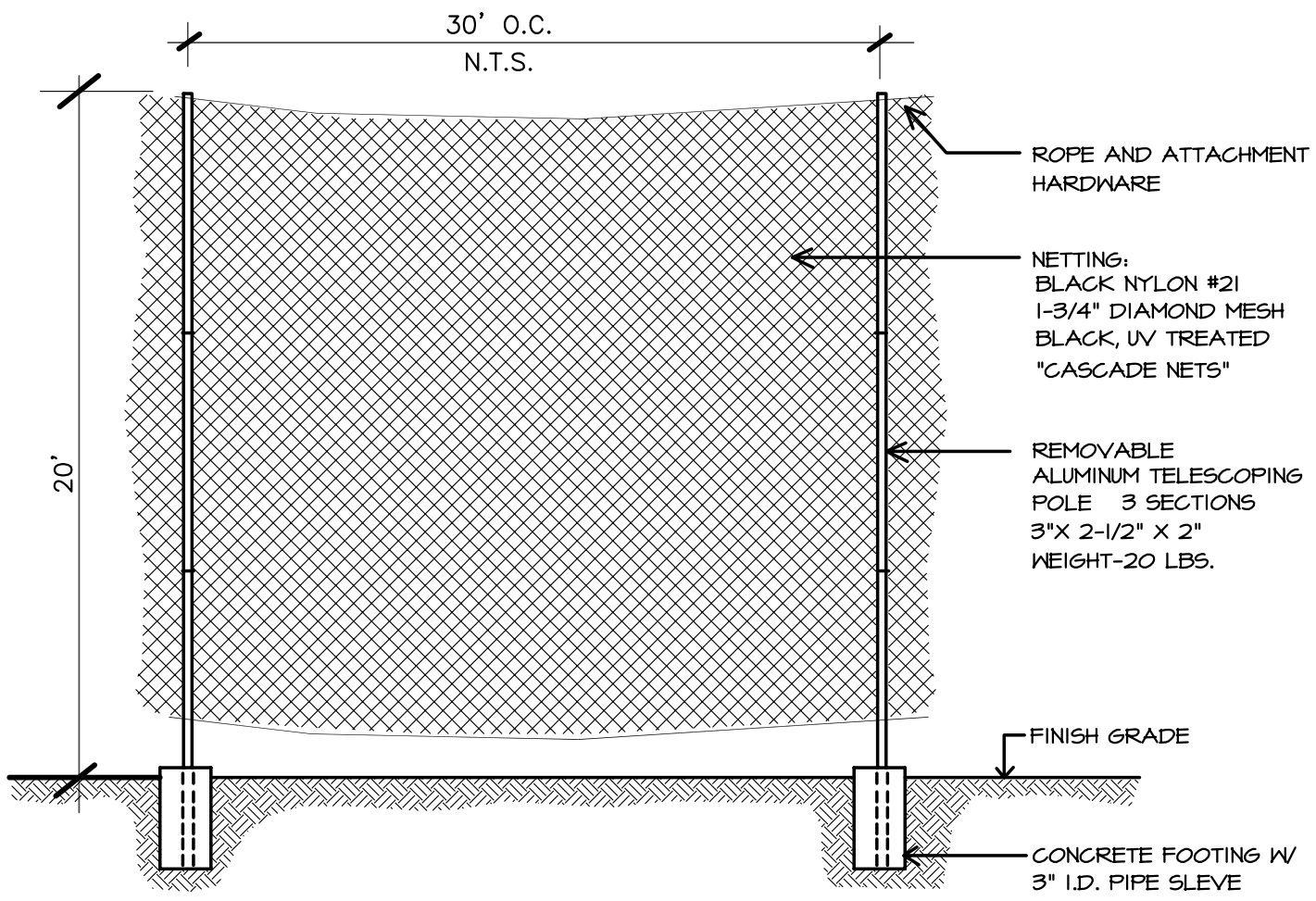

PARTIONAL FENCE ELEVATION
SCALE: NOT TO SCALE

EXHIBIT B SPORTS FIELD TEMPORARY NETTING FENCE
30800 PALOS VERDES DRIVE EAST
MARYMOUNT COLLEGE

RASMUSSEN & ASSOCIATES
DECEMBER 1, 2008
*Architecture
Planning
Interiors*

TEMPORARY NETTING FENCE FOR EVENTS. NETTING TO BE 20' HIGH WITH TELESCOPING POLES AT 30' O.C.

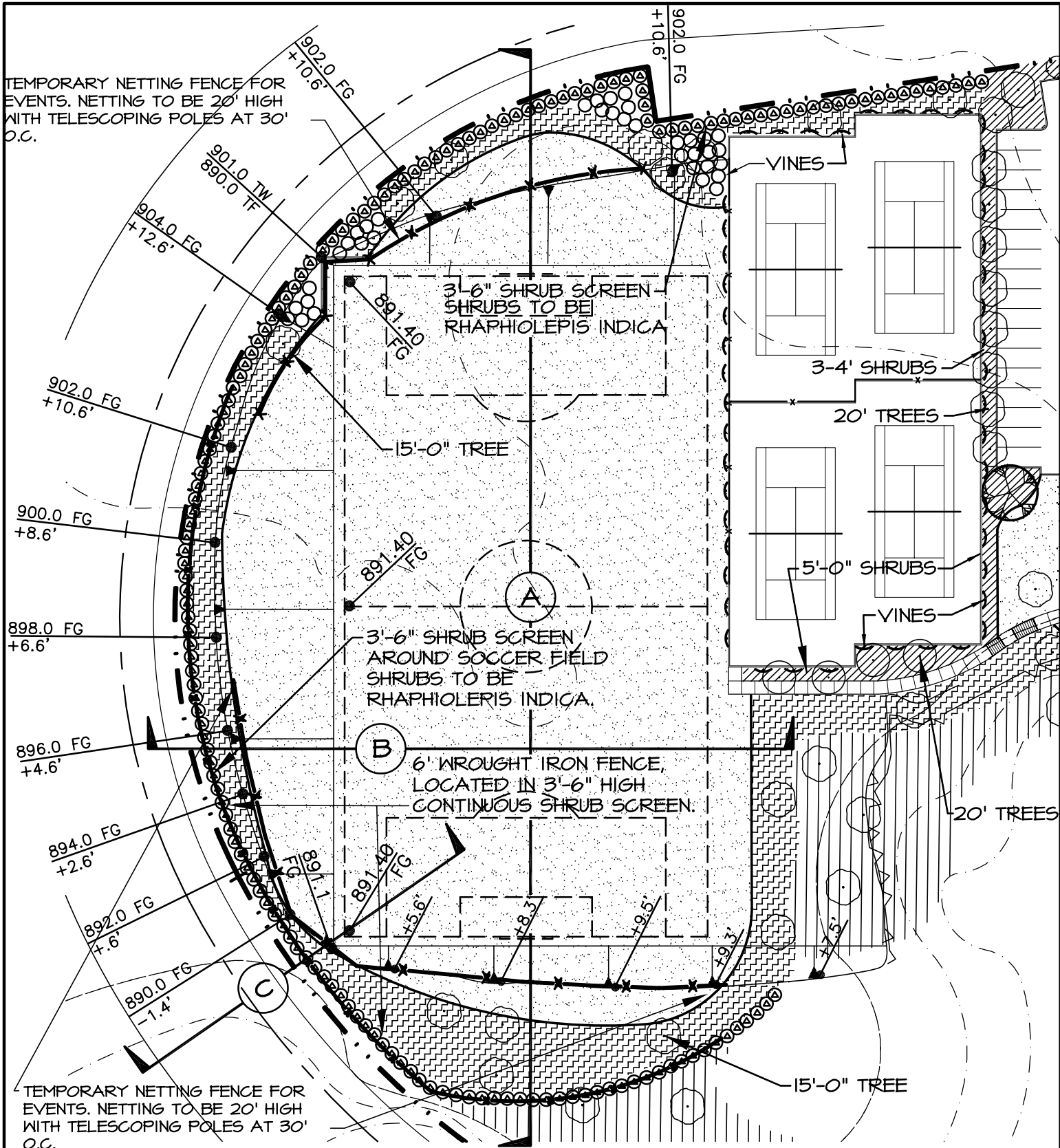

TEMPORARY NETTING FENCE FOR EVENTS. NETTING TO BE 20' HIGH WITH TELESCOPING POLES AT 30' O.C.

PARTIAL SITE PLAN

SCALE: 1" = 60'-0"



NOTE: THE PLAYING SURFACE OF THE SOCCER FIELD IS DEPRESSED (2:1 SLOPE BANK) WITH A CONTINUOUS LANDSCAPE SCREEN AROUND THE FIELD OF APPROXIMATELY 3'-6" FEET TALL, A 6' BLACK IRON FENCE WILL BE EMBEDDED IN THE HEDGE SCREEN, AS SHOWN.

EXHIBIT A SPORTS FIELD/TENNIS COURT PLANTING
 30800 PALOS VERDES DRIVE EAST
 MARYMOUNT COLLEGE

RASMUSSEN & ASSOCIATES
 JANUARY 6, 2009

Architecture
 Planning
 Interiors

SITE SECTIONS
SCALE: 1" = 60'-0"

EXHIBIT B SITE SECTION SPORTS FIELD
30800 PALOS VERDES DRIVE EAST
MARYMOUNT COLLEGE

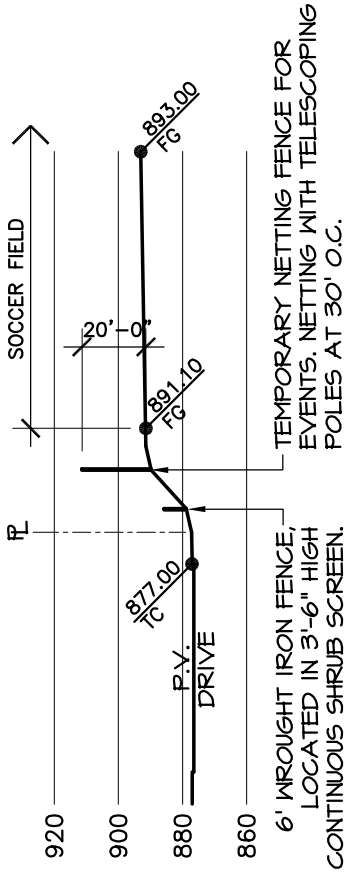

C SITE SECTION
SCALE 1" : 60'-0"

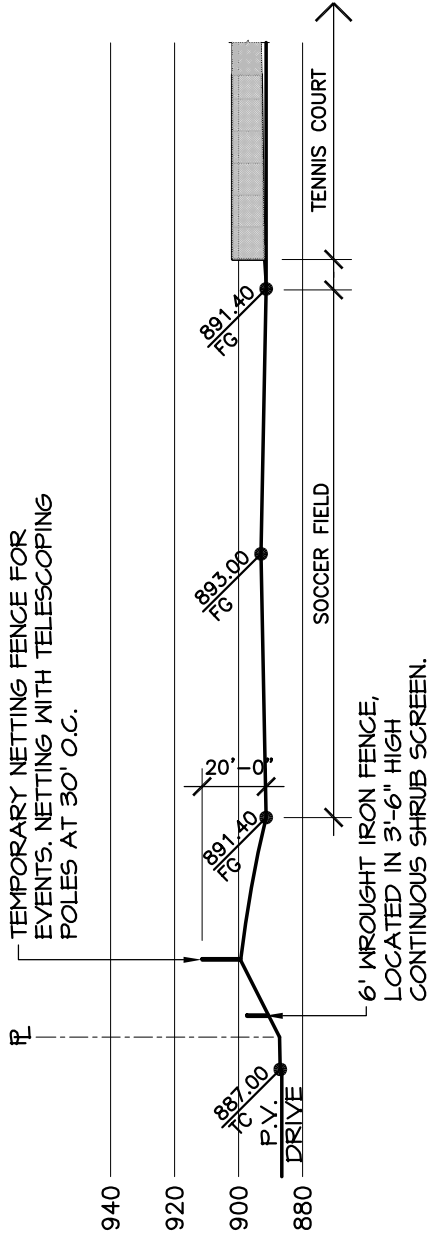

B SITE SECTION
SCALE 1" : 60'-0"

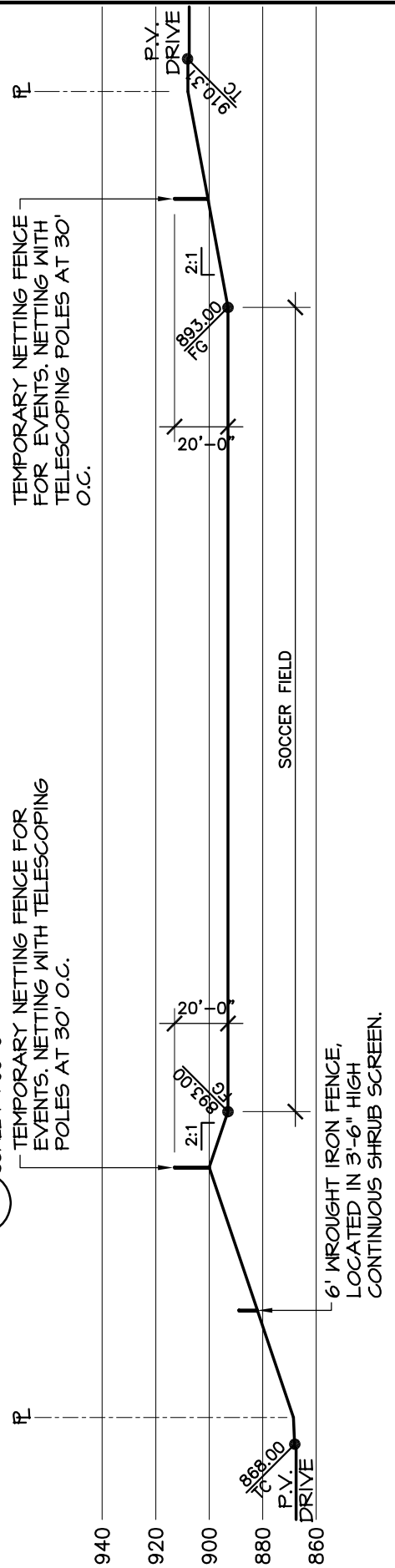

A SITE SECTION
SCALE 1" : 60'-0"